

1020 CROWLEY DRIVE

CARROLLTON, TX 75006



±88,233 SF

AVAILABLE FOR SALE OR LEASE

SUMMER 2025



PROPERTY HIGHLIGHTS

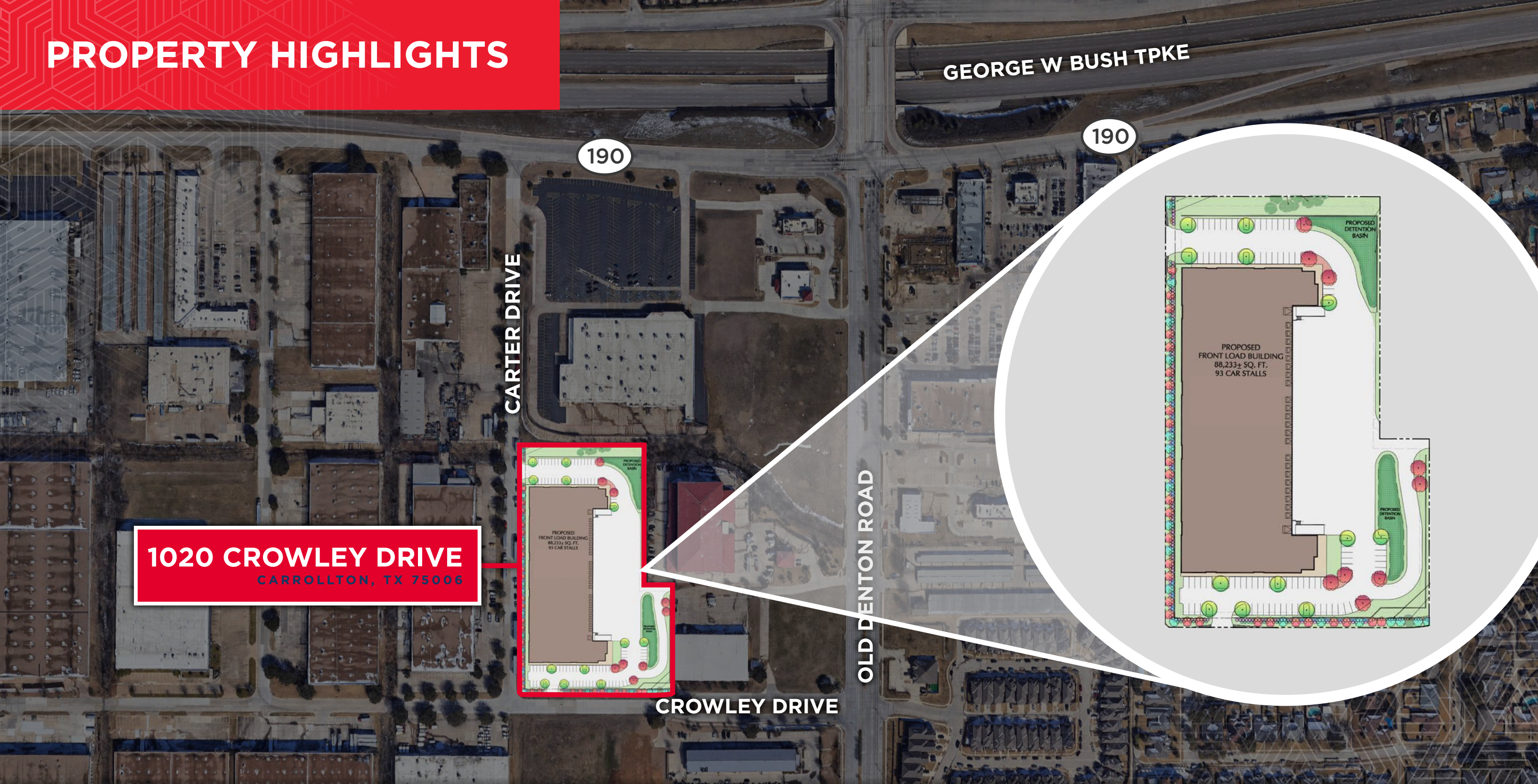

1020 CROWLEY DRIVE
CARROLLTON, TX 75006

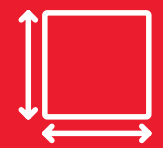
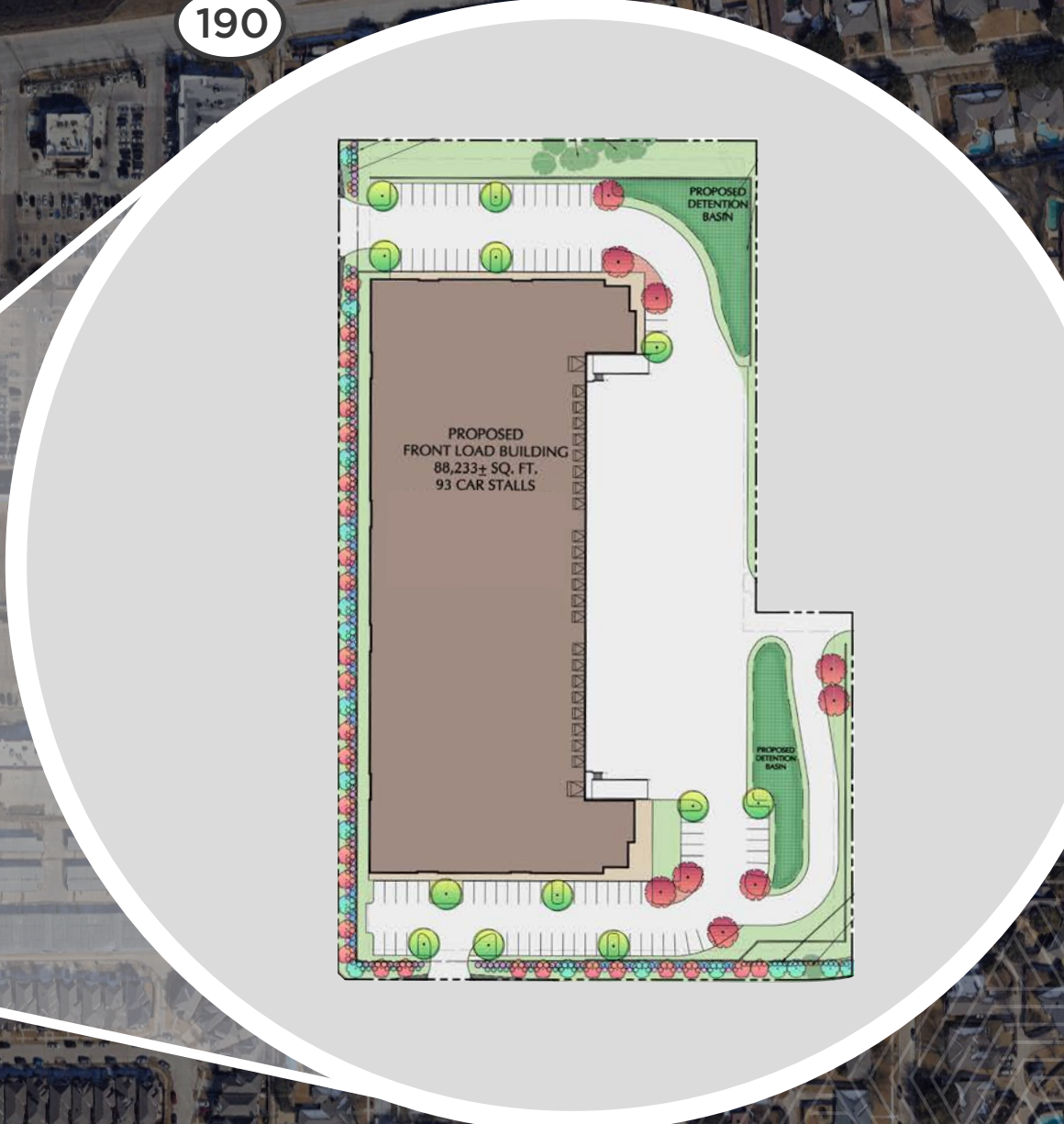
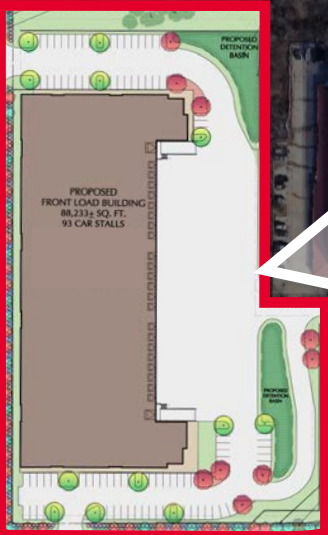

±88,233
SF



32'
CLEAR HEIGHT



22
DOCK HIGH DOORS



2
RAMPED DOORS



94
CAR PARKS



Access to I-35 & George W Bush Turnpike:
2.5 Minutes | 1.7 Miles

1020 CROWLEY DRIVE
CARROLLTON, TX 75008

I-35 & George W Bush Tpke

EST. 1944
Porter
LIGHTING

 **Smith System**

TreeHouse
FOODS

 **JPG**
Johnson
Plastic
Group
Extrusion Solutions

Rudy's
Tortillas

BLS
SERVICES

TRANE

de-sl

amazon

BSN SPORTS

iff

BUNZL

MOORE Supply Co.

FOR MORE INFORMATION, PLEASE CONTACT:

DAVID ESEKE, SIOR
Vice Chairman
Industrial Tenant Advisory
& Leasing Leader - Dallas
+1 972 663 9852
david.eseke@cushwake.com

CLAY BALCH, SIOR
Executive Director
+1 972 663 9853
clay.balch@cushwake.com

JAY BENNER
Director
+1 205 864 7086
jay.benner@cushwake.com

Developed by:

 **ALLIANCE**
INDUSTRIAL COMPANY

 **CUSHMAN & WAKEFIELD**

©2024 Cushman & Wakefield. All rights reserved. The information contained in this communication is strictly confidential. This information has been obtained from sources believed to be reliable but has not been verified. NO WARRANTY OR REPRESENTATION, EXPRESS OR IMPLIED, IS MADE AS TO THE CONDITION OF THE PROPERTY (OR PROPERTIES) REFERENCED HEREIN OR AS TO THE ACCURACY OR COMPLETENESS OF THE INFORMATION CONTAINED HEREIN, AND SAME IS SUBMITTED SUBJECT TO ERRORS, OMISSIONS, CHANGE OF PRICE, RENTAL OR OTHER CONDITIONS, WITHDRAWAL WITHOUT NOTICE, AND TO ANY SPECIAL LISTING CONDITIONS IMPOSED BY THE PROPERTY OWNER(S). ANY PROJECTIONS, OPINIONS OR ESTIMATES ARE SUBJECT TO UNCERTAINTY AND DO NOT SIGNIFY CURRENT OR FUTURE PROPERTY PERFORMANCE.